

Maitrise d'Ouvrage

L'Assurance Maladie
866 Rue des Fraisses
42350 LA TALAUDIERE



Installation des panneaux solaires photovoltaïques

CTI Saint-Etienne
866 Rue des Fraisses
42350 LA TALAUDIERE

Dossier de Consultation des Entreprises

ARCHITECTE :



10 rue Beau de Rochas - 63110 BEAUMONT
Tél : 06.40.48.73.37 - Mail : contact@archidistec.com
www.archidistec.com

N° Affaire: 25-33 Date: 30/01/2026

Pièces graphiques

DCE

Date	Modifications	Indice
30/01/2026	Mise à jour des panneaux photovoltaïques	Ind.1

Situation du projet

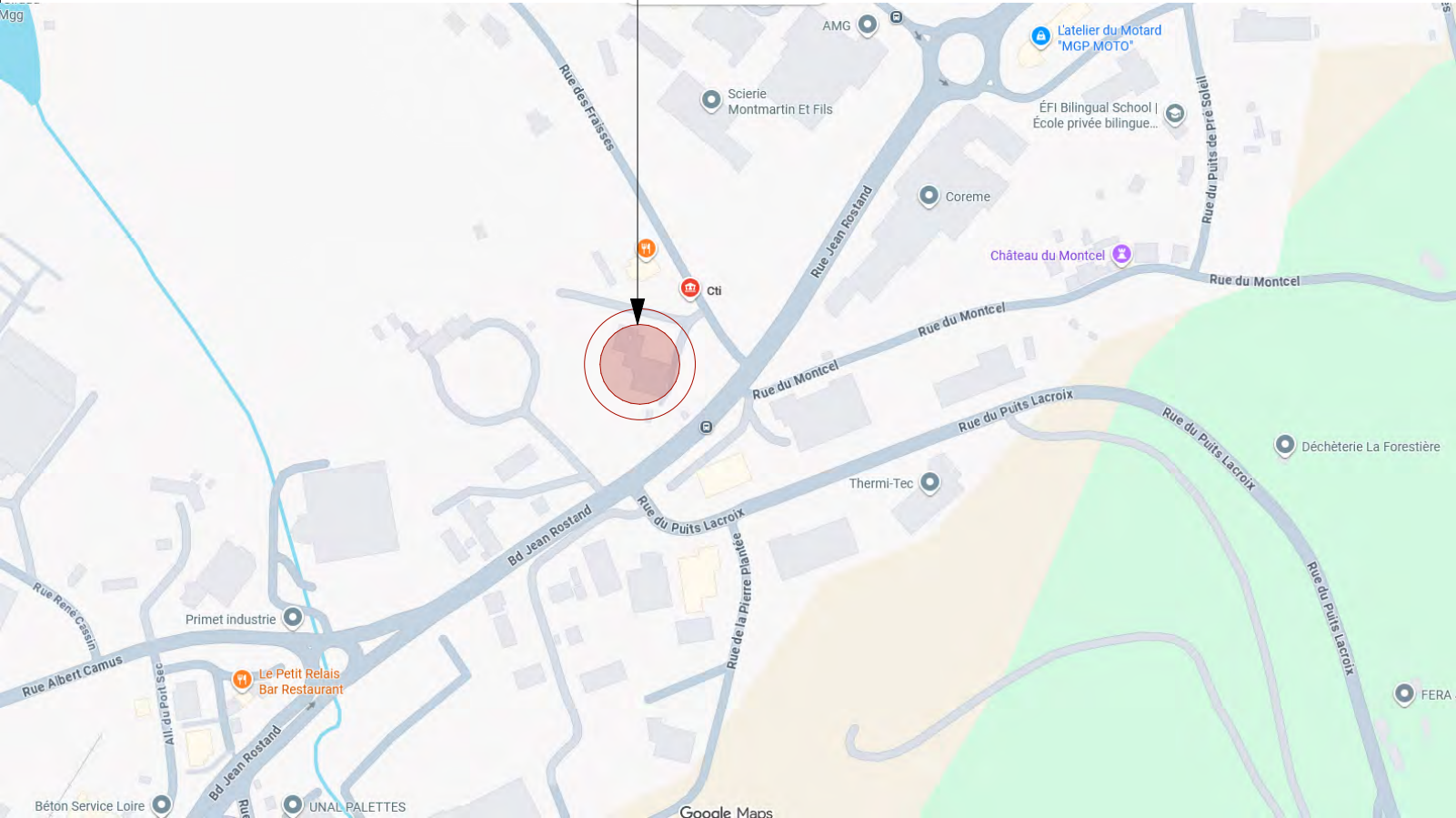

Plan de situation



Vue aérienne

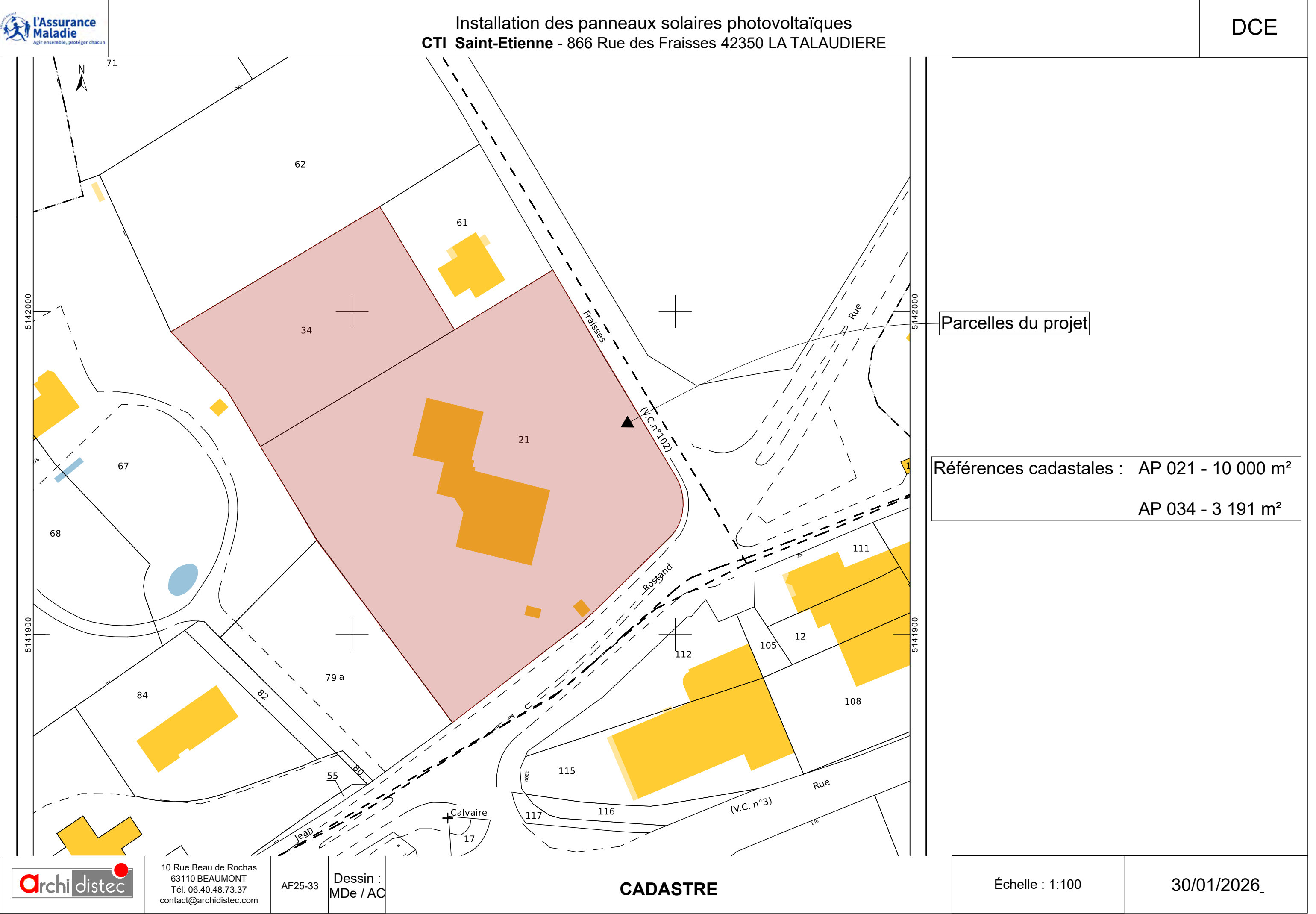





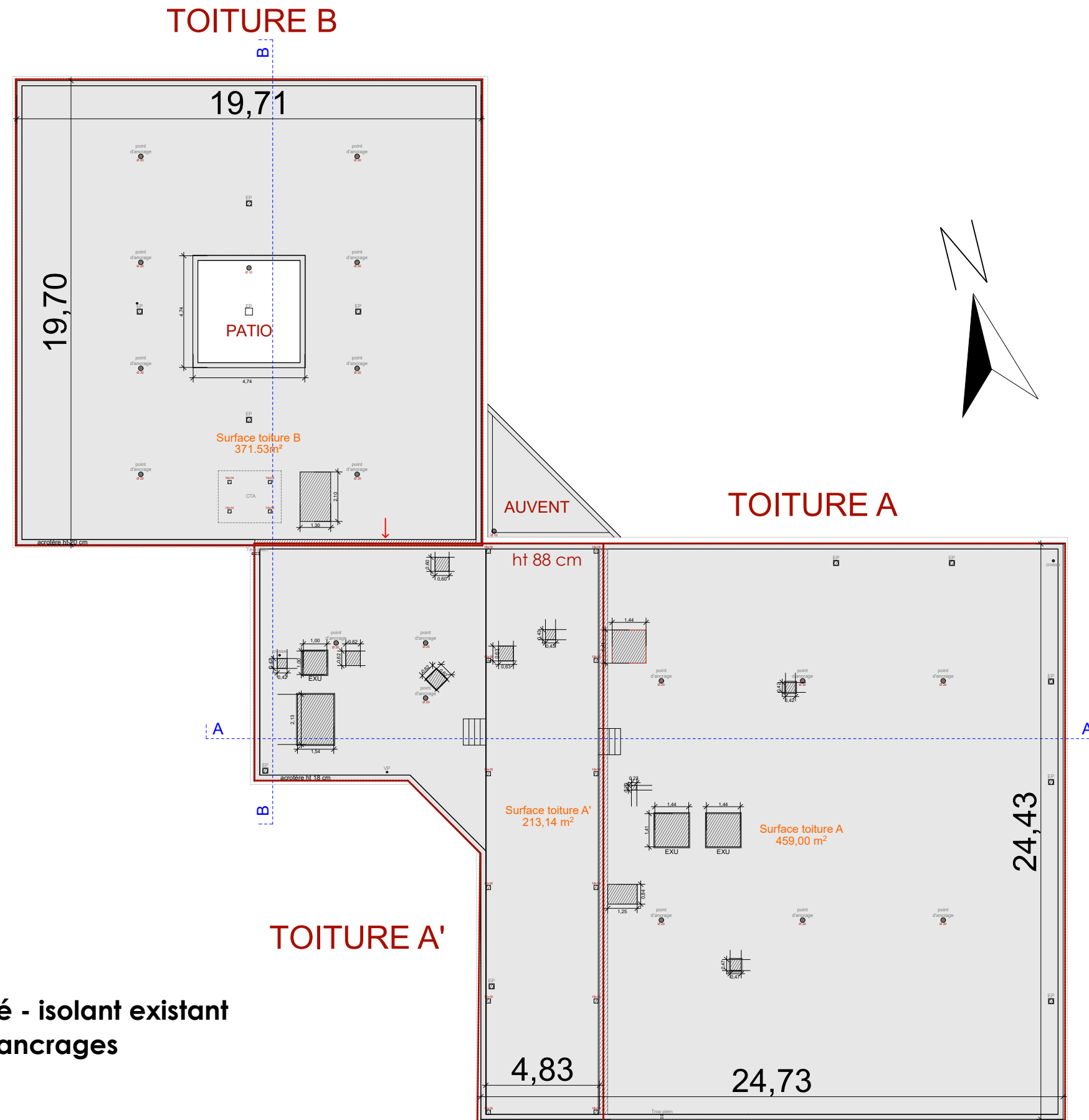

Dépose gravillons - étanchéité - isolant existant
Dépose des points d'ancrages

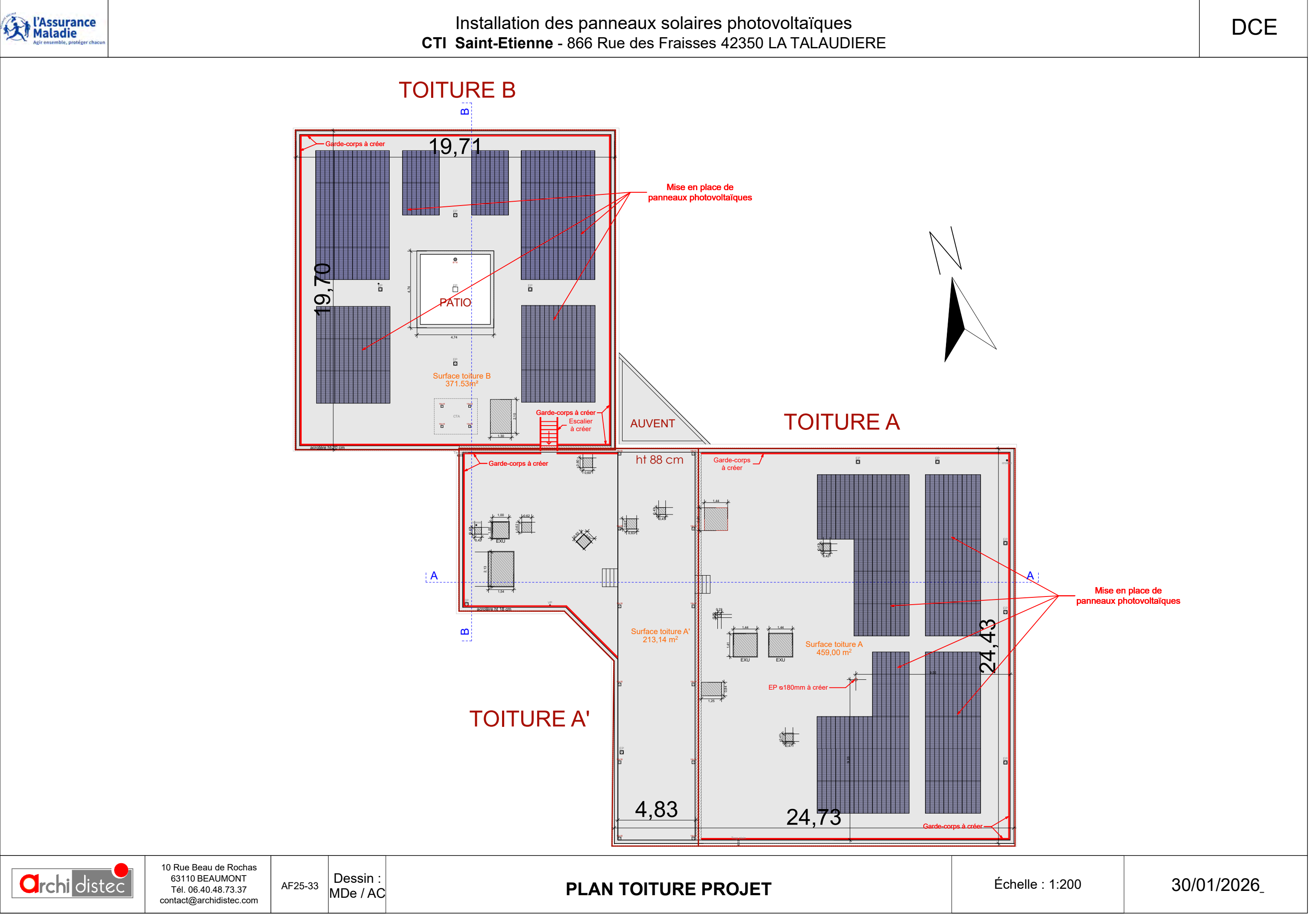

Etage inchangé

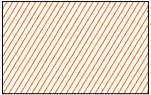
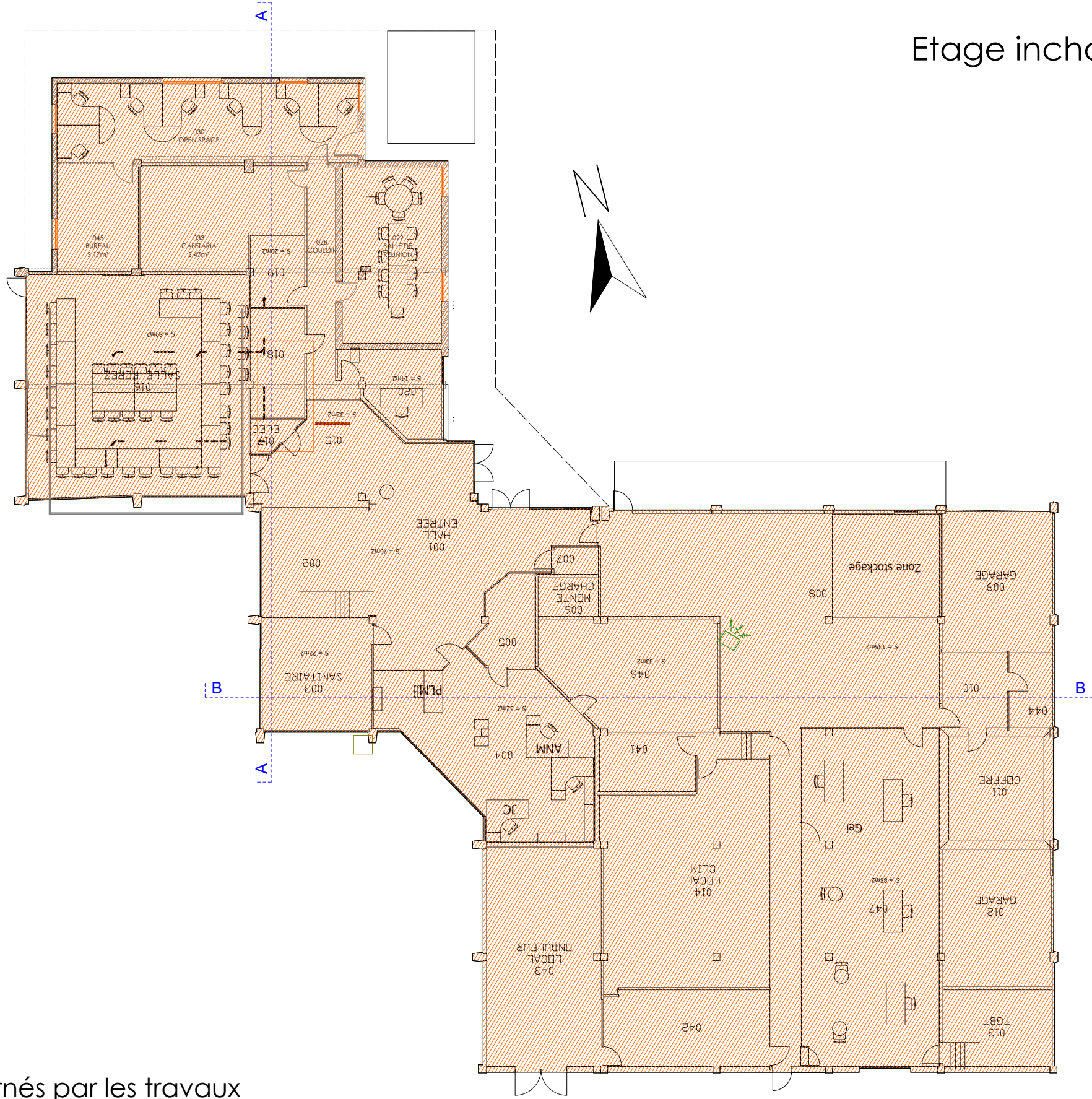

Locaux non concernés par les travaux

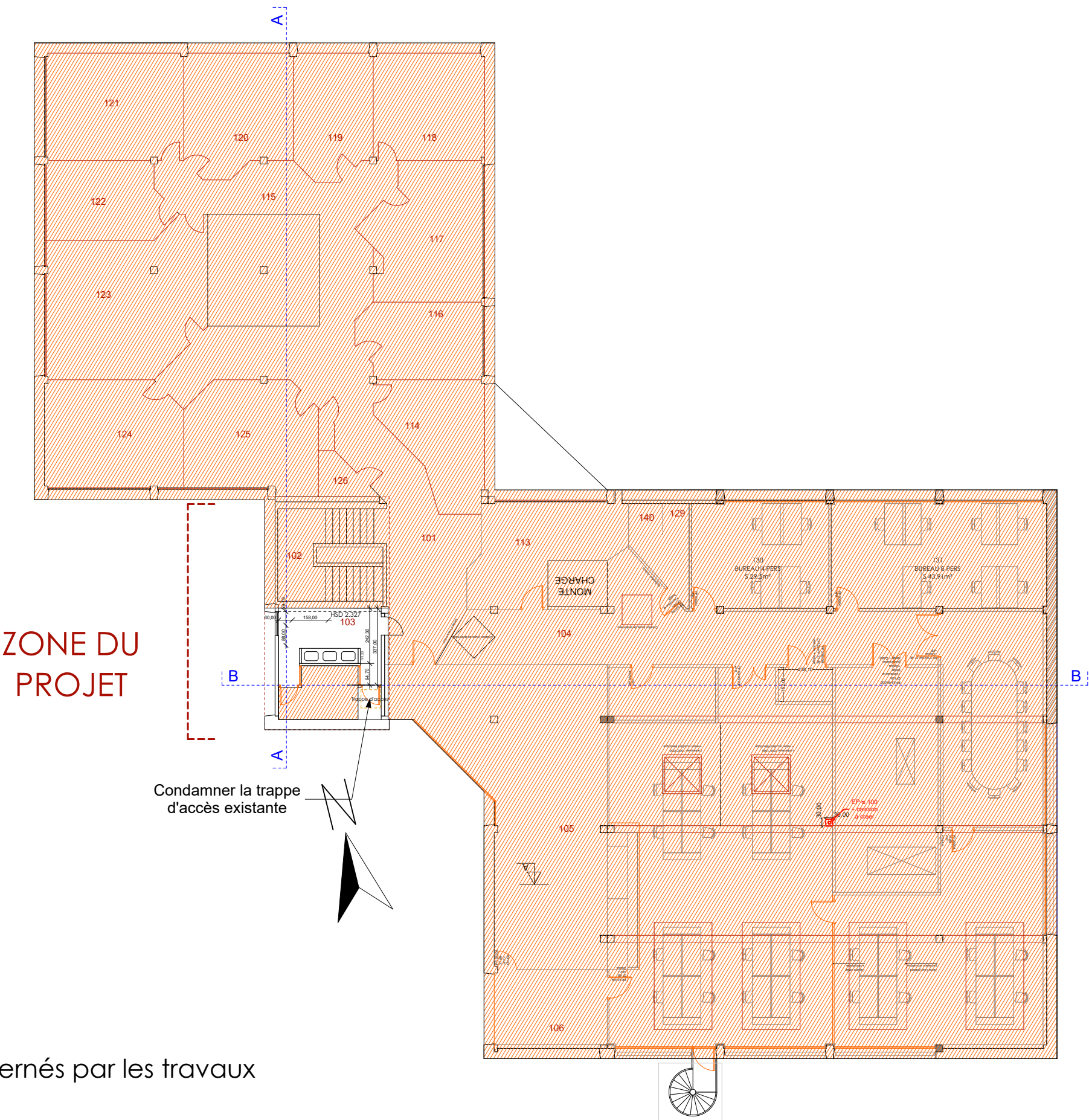

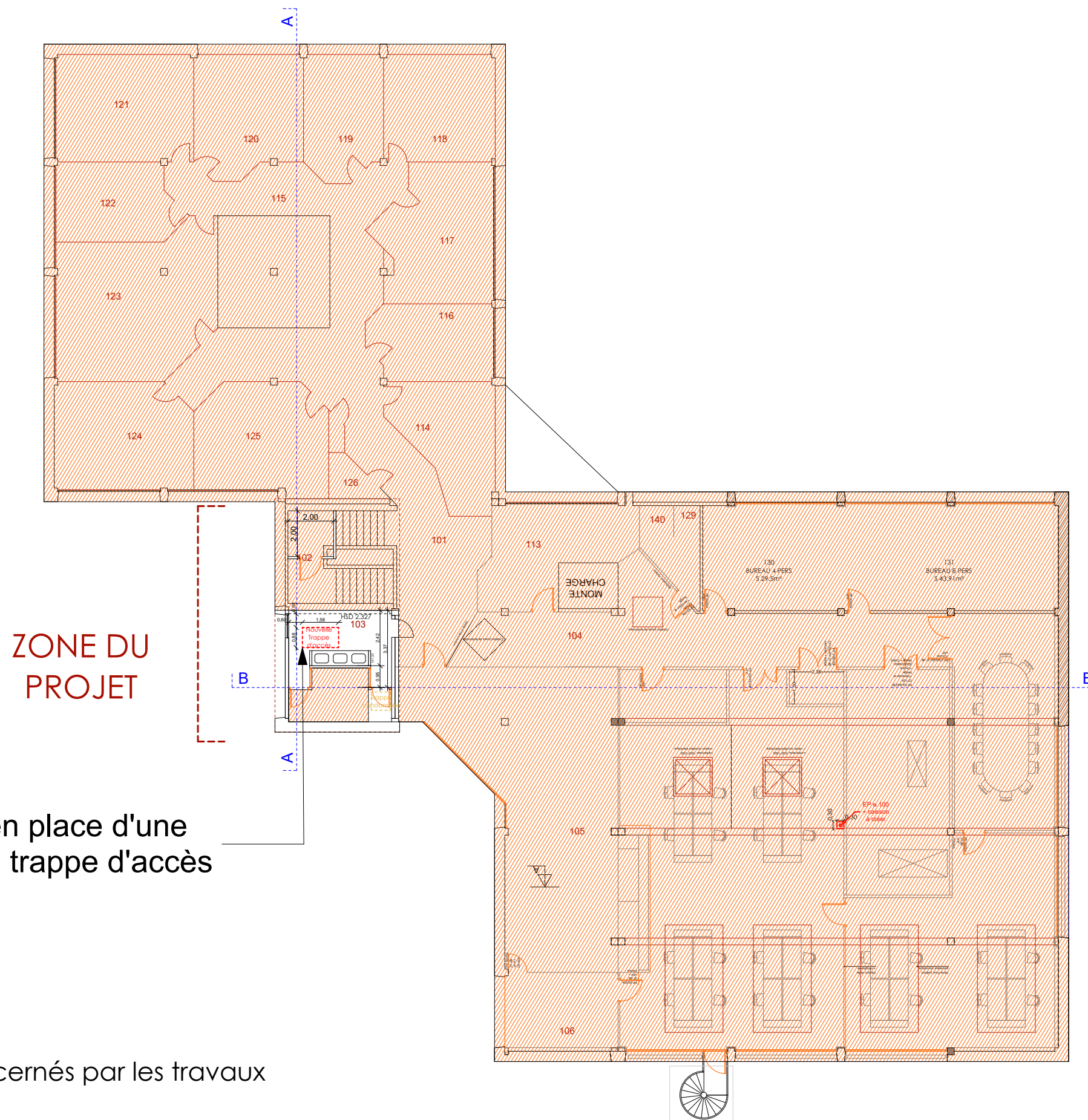

ZONE DU
PROJET

Mise en place d'une
nouvelle trappe d'accès

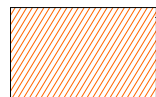

Locaux non concernés par les travaux

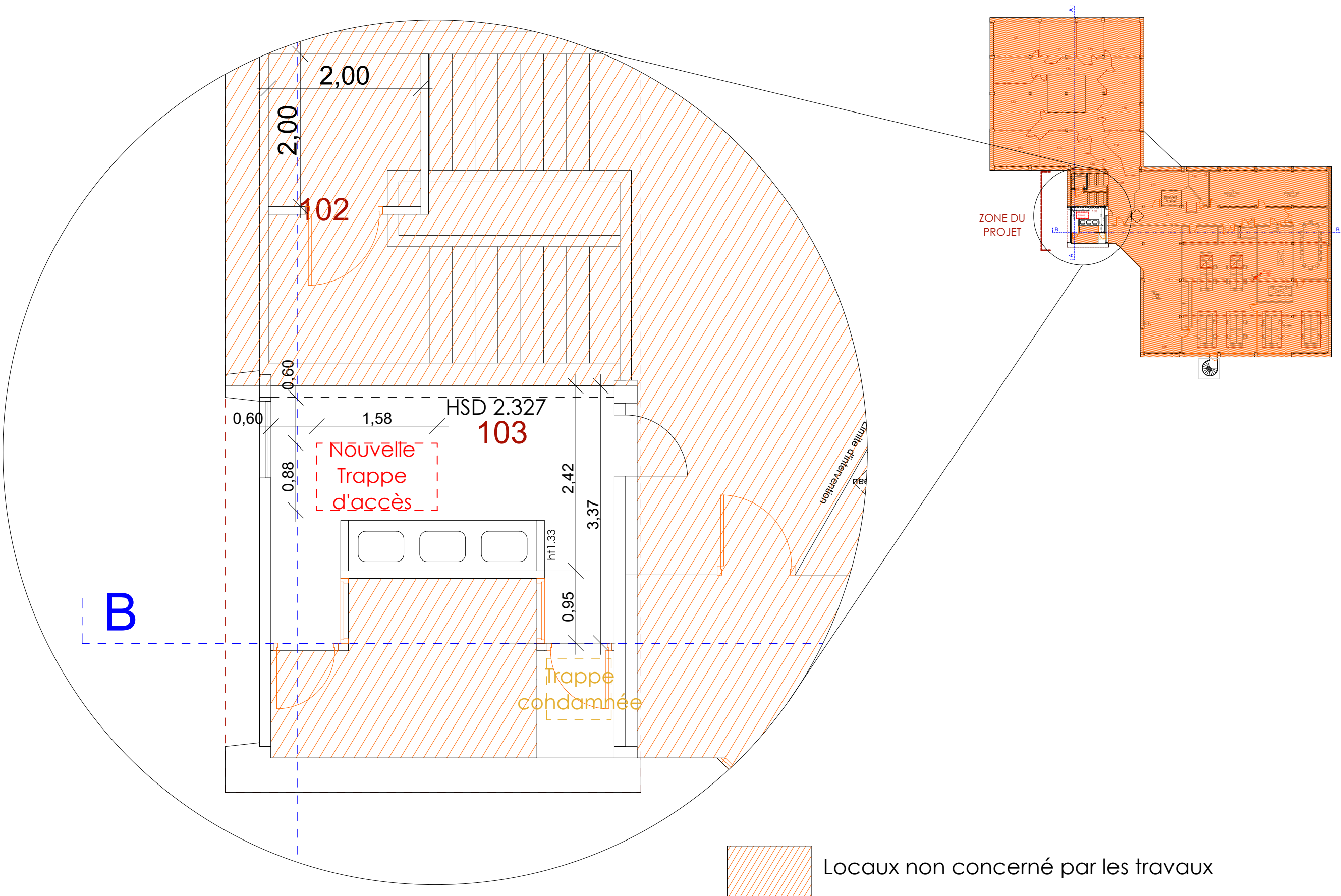

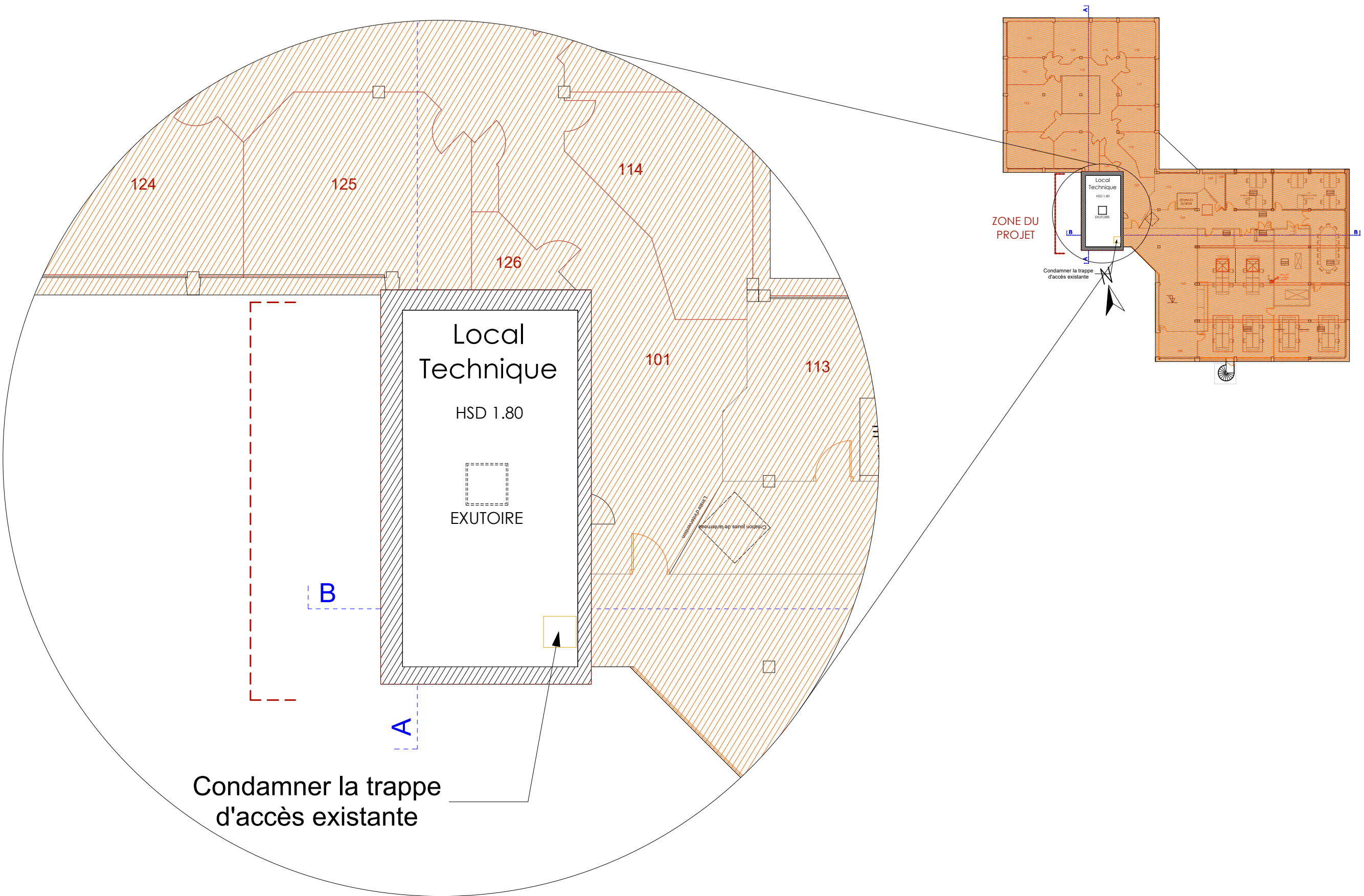

Condamner la trappe
d'accès existante

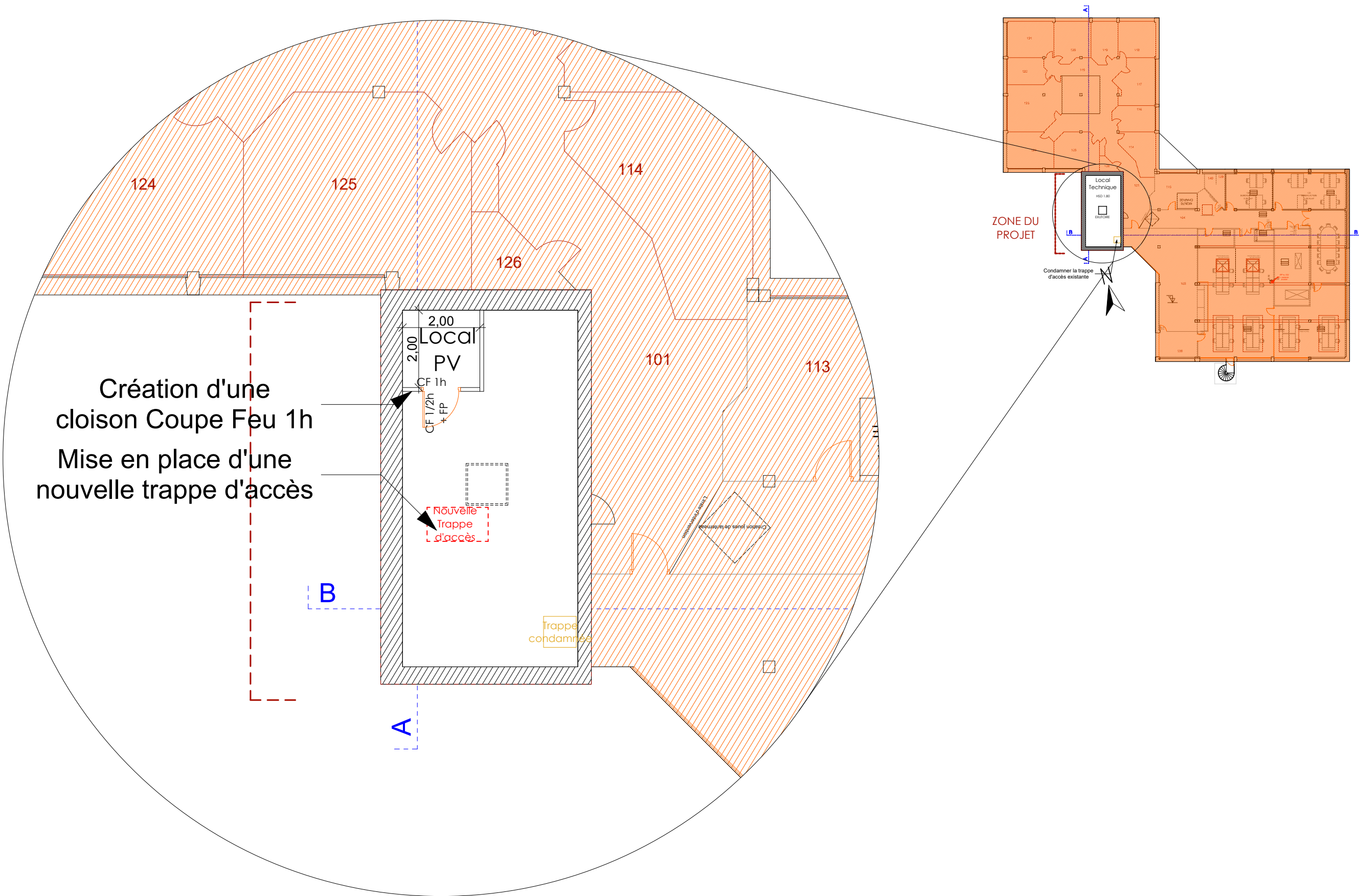

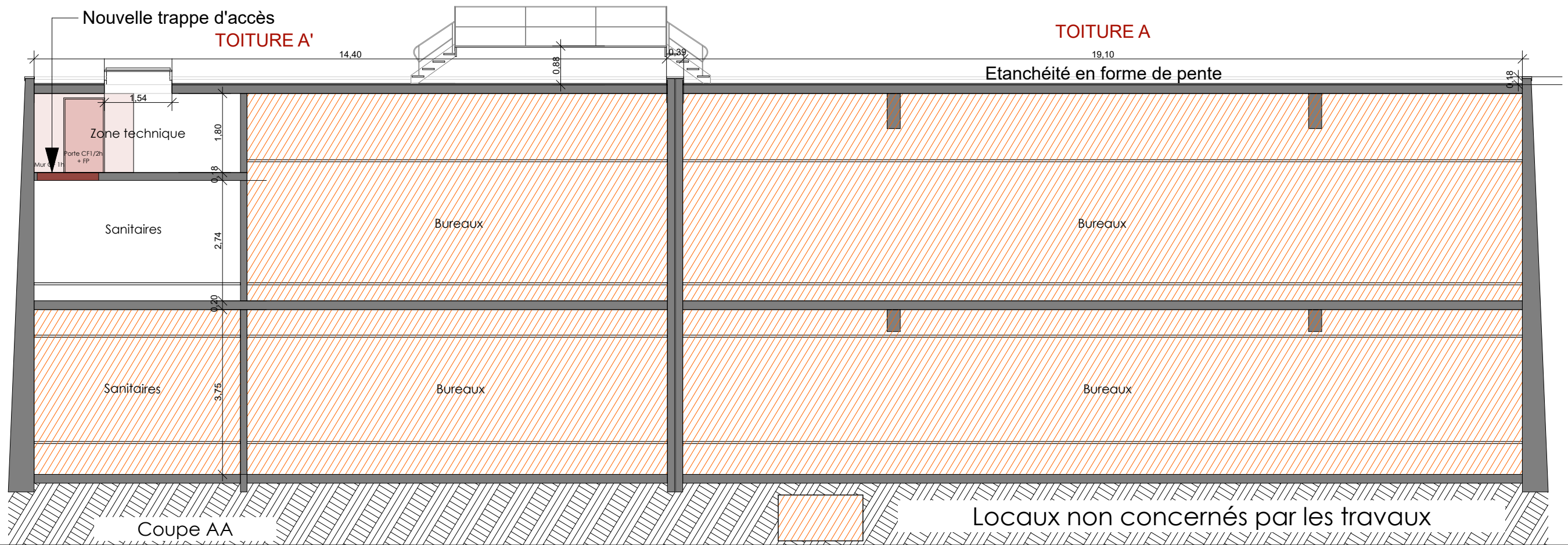
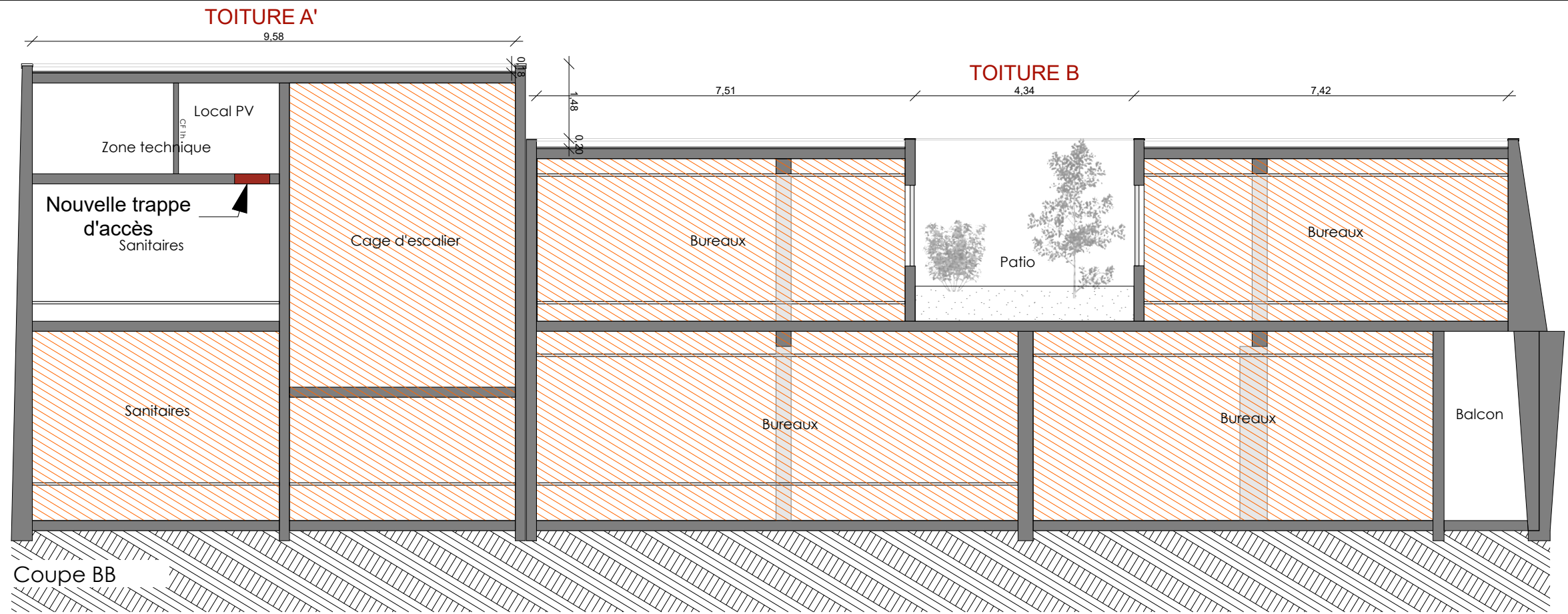

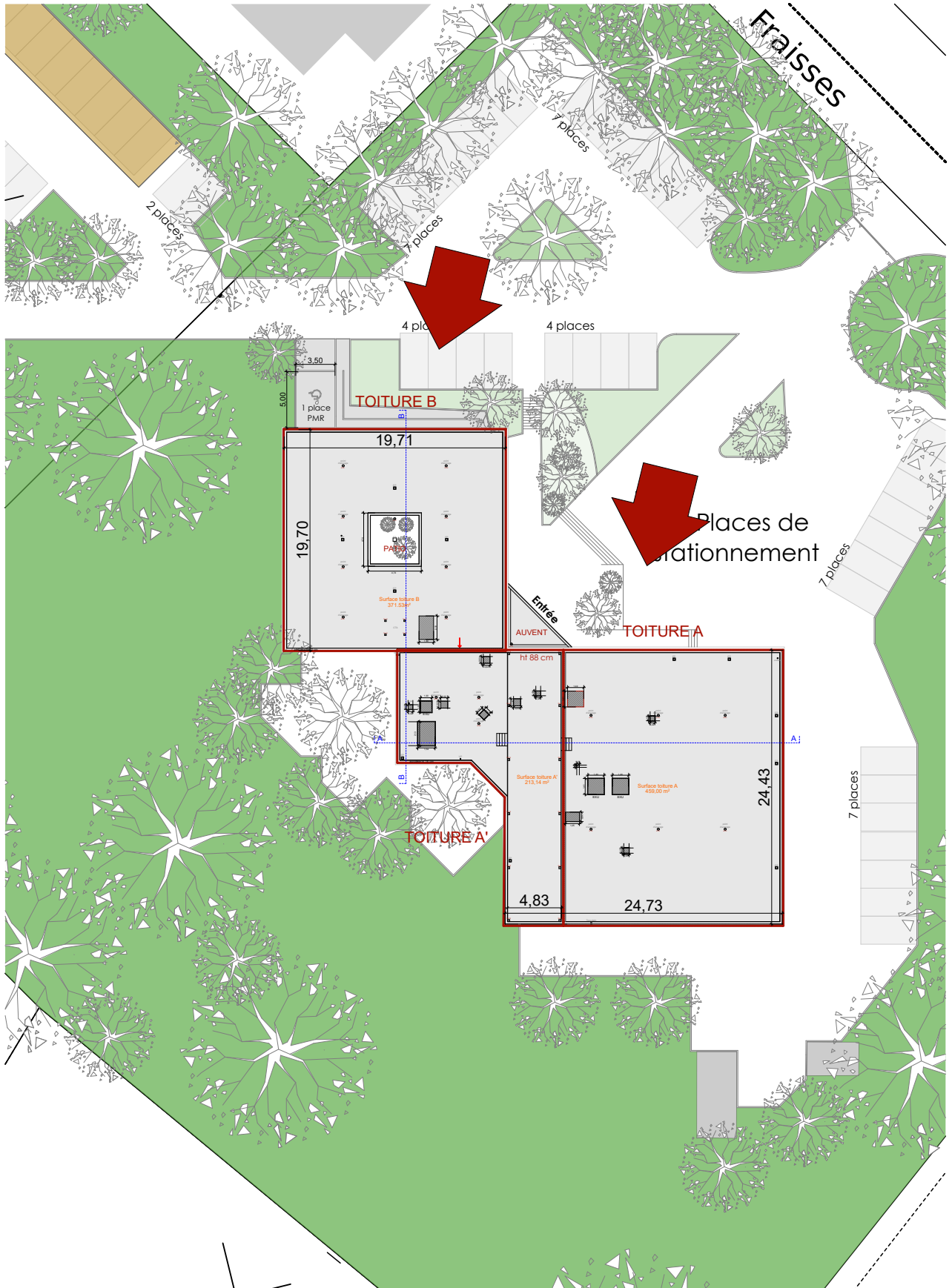

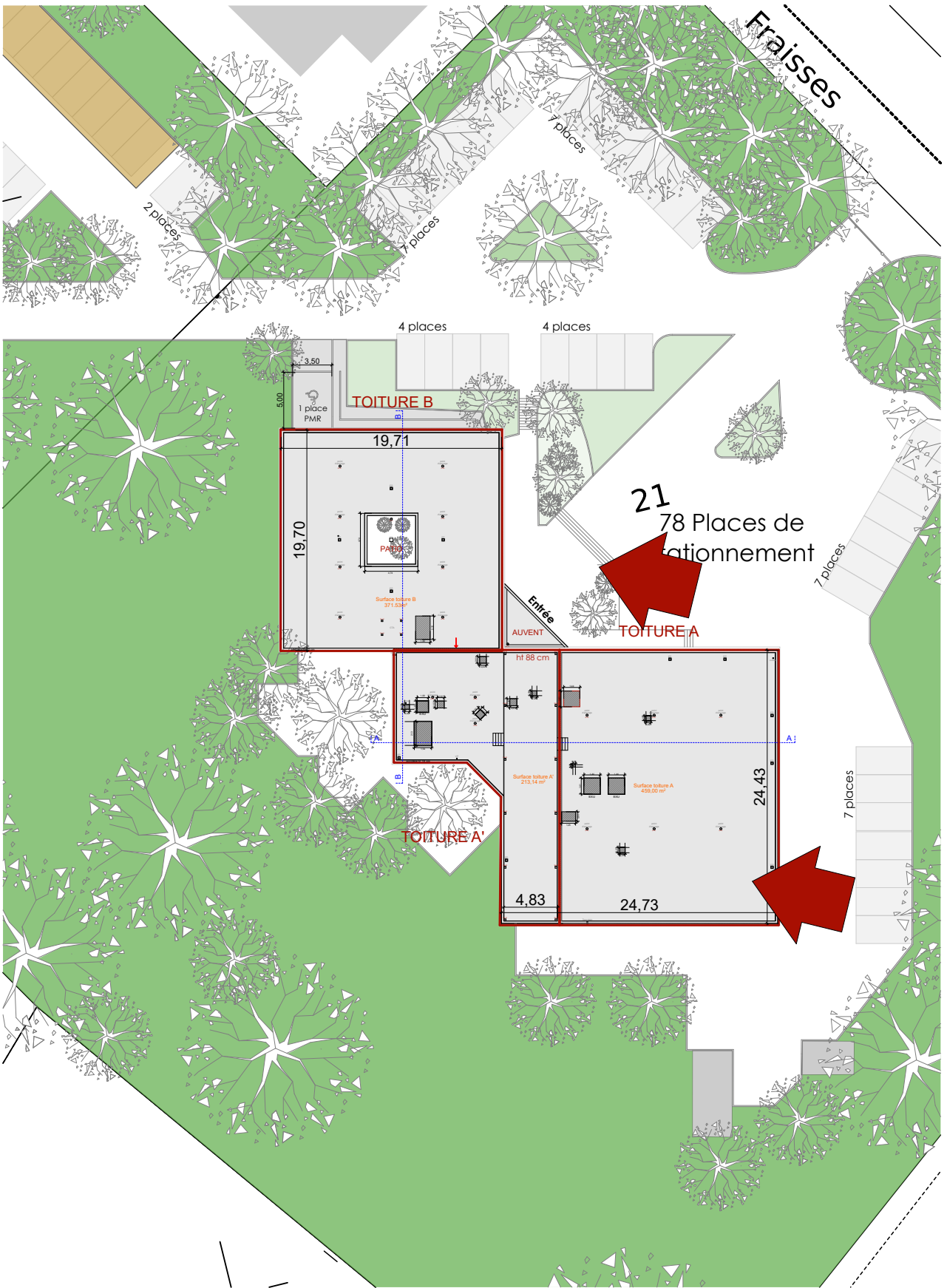

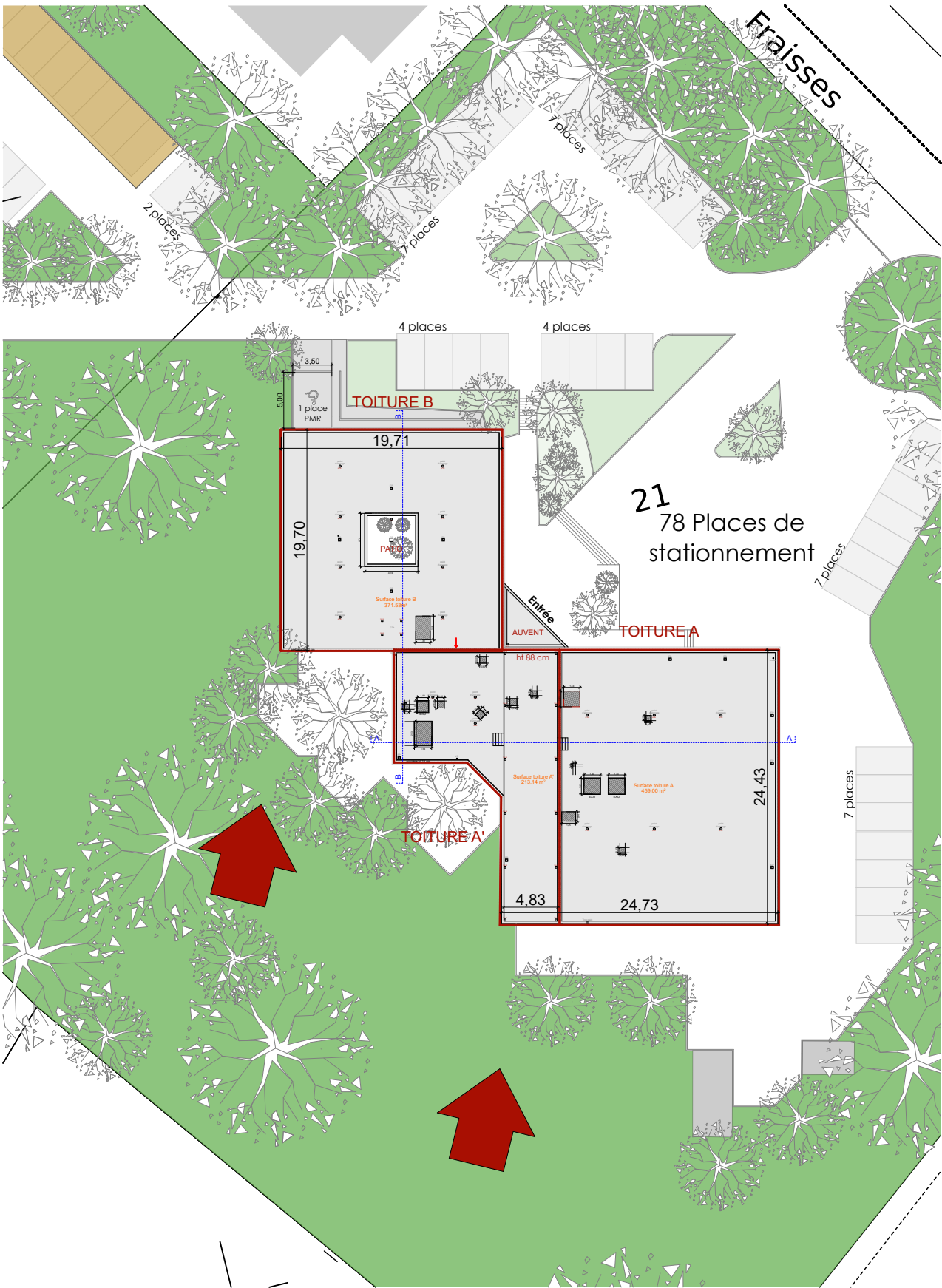

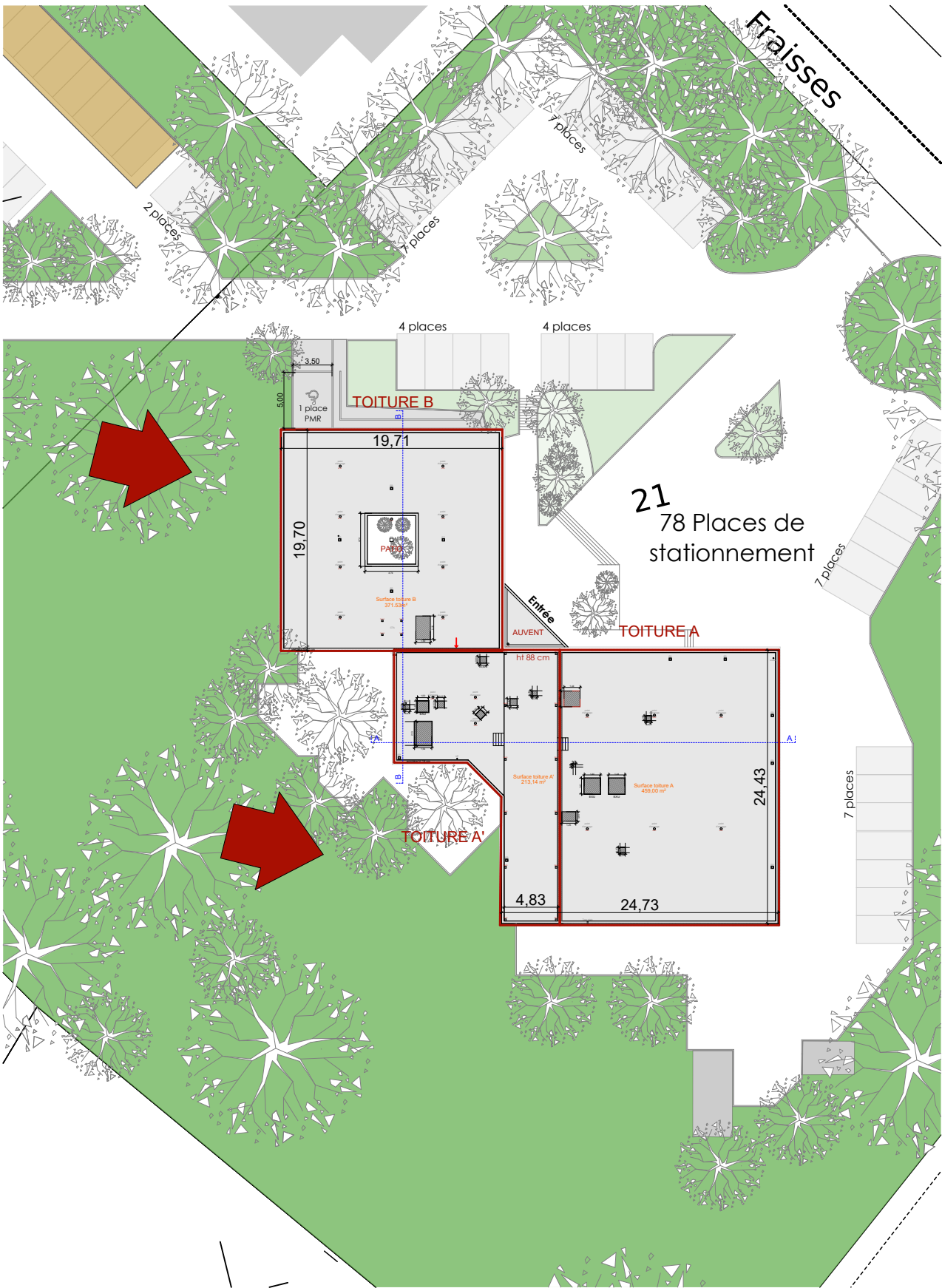

Toiture A & B :

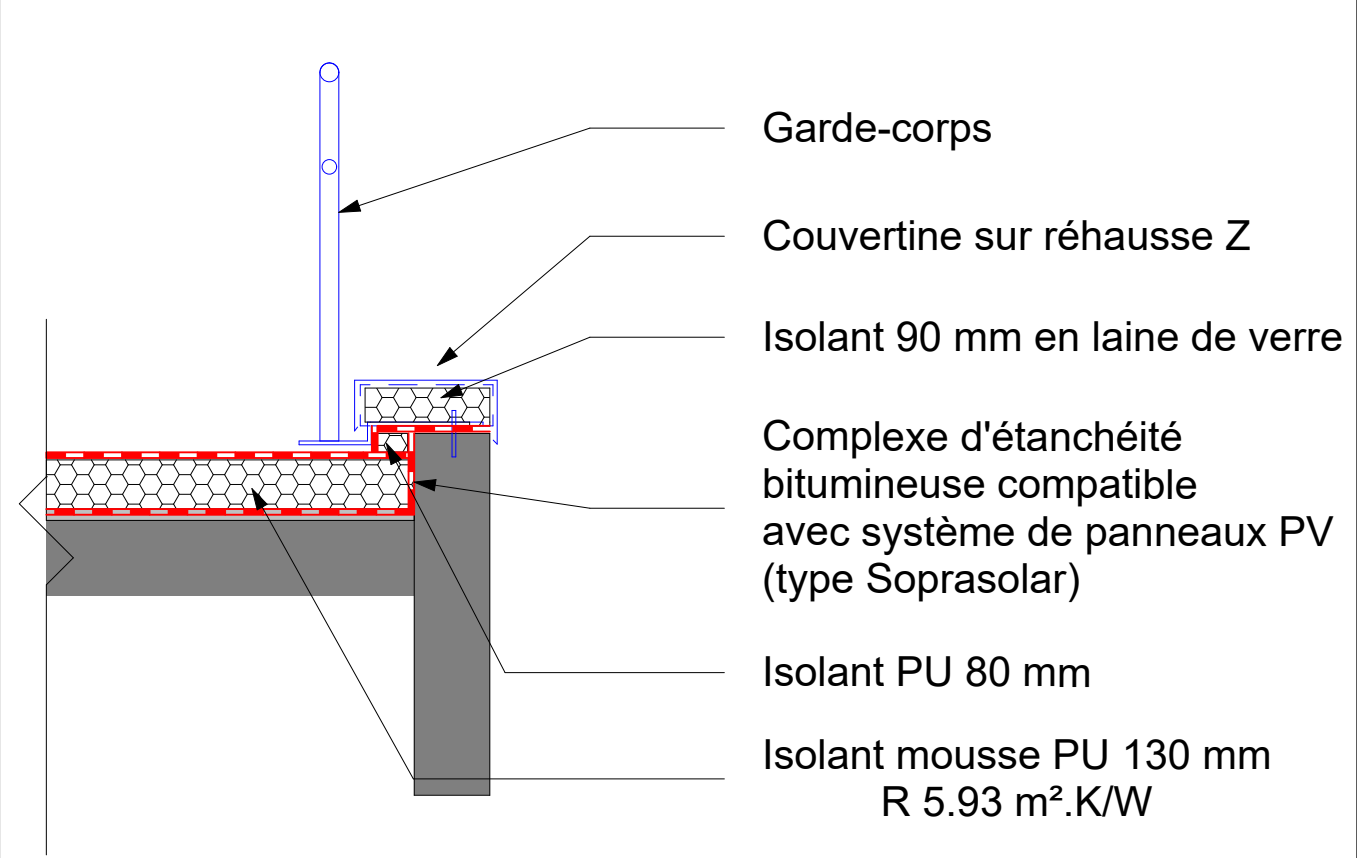

Auvent :

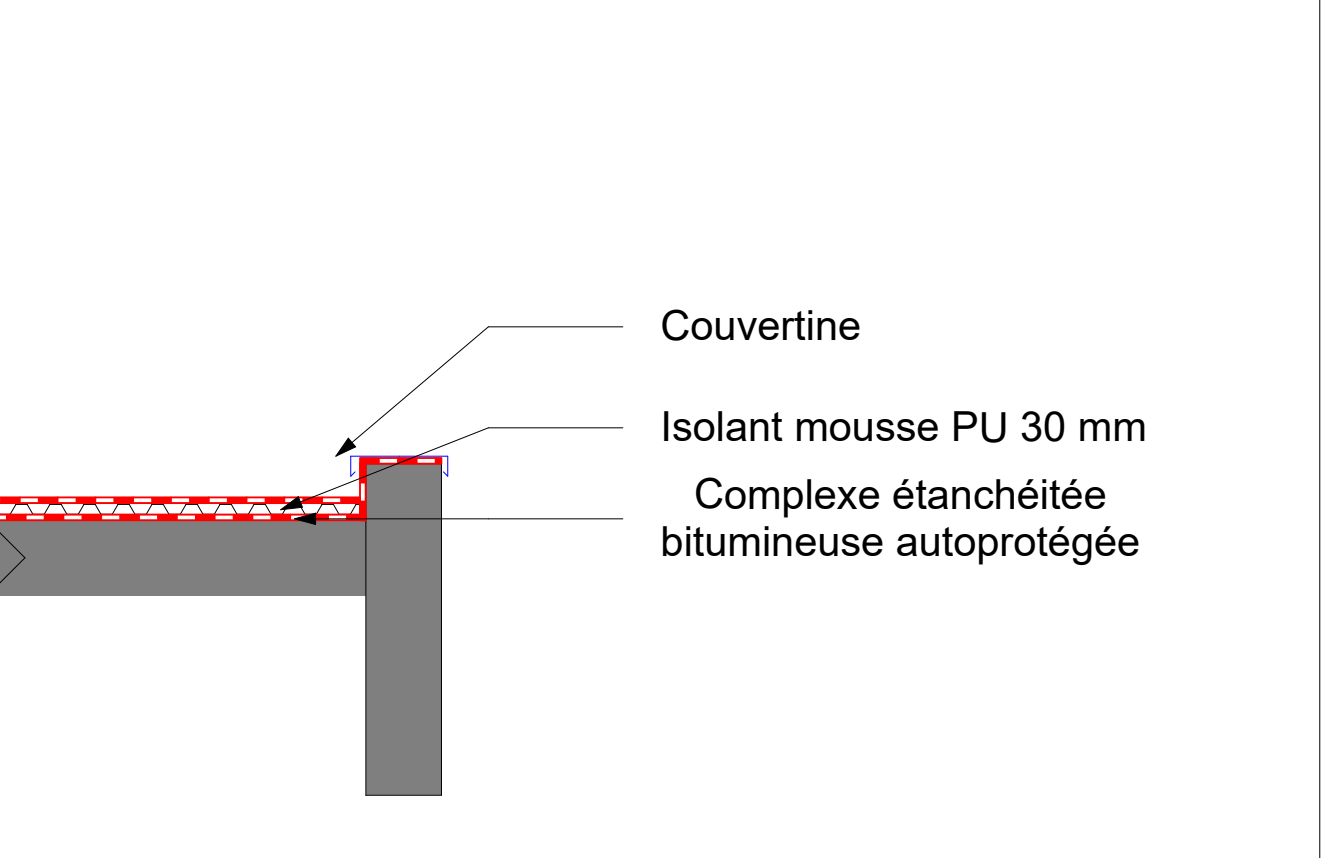

Patio :

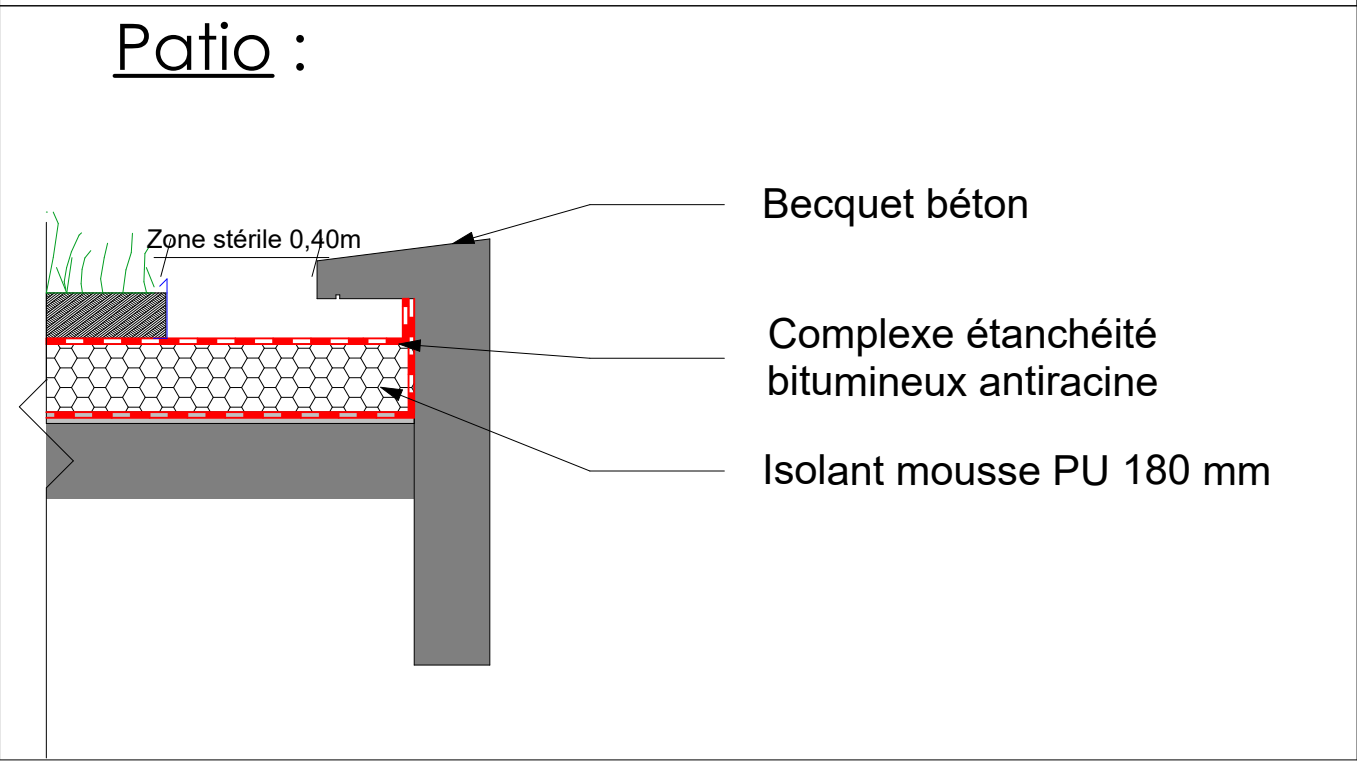

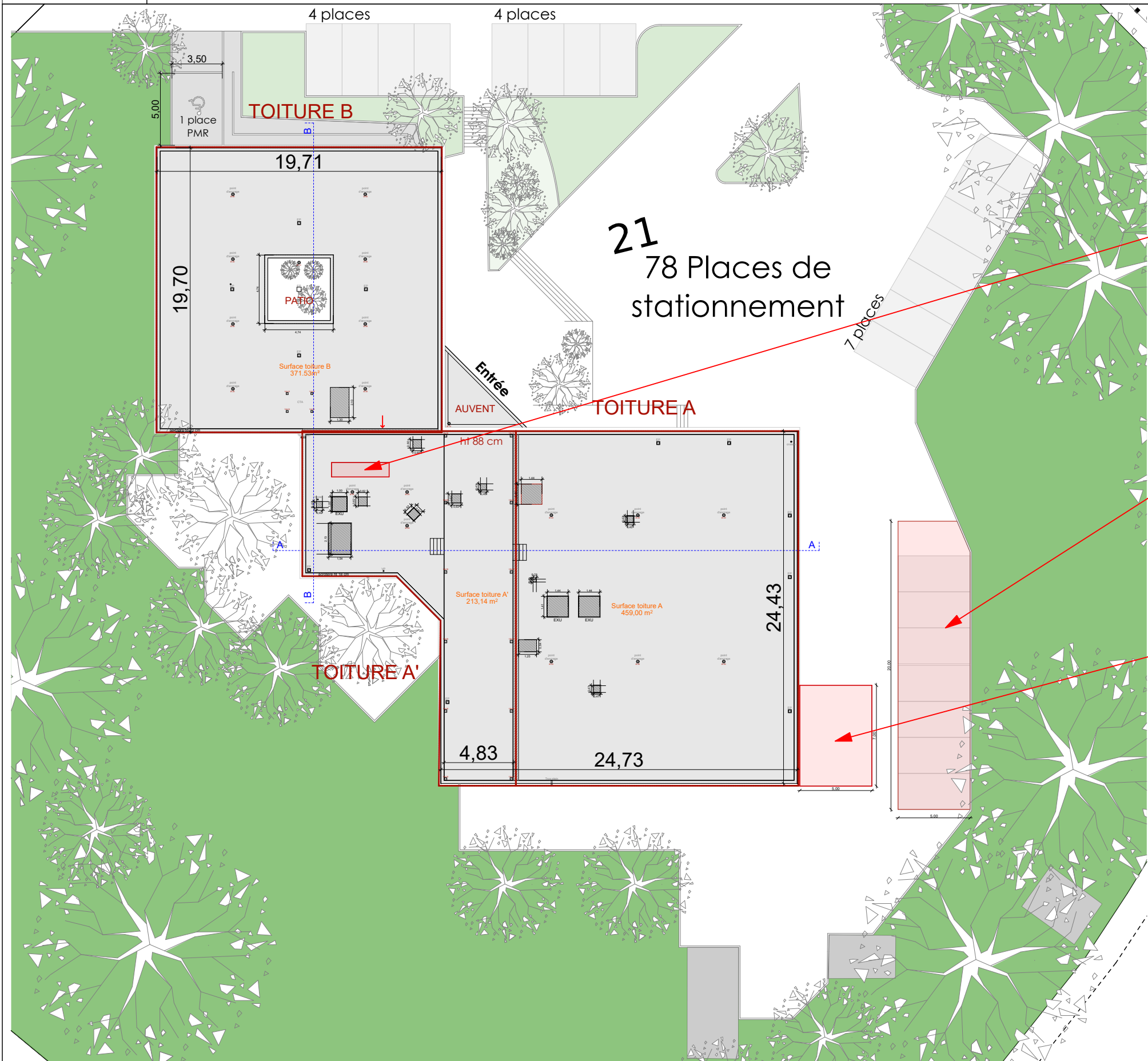

Sas de décontamination
amiante 100 x 400 cm

Zone de stockage
matériaux avec
barrières de chantier

Tourelle d'accès chantier
avec barrières de chantier

Base-vie mise à
disposition par le
MOA à l'intérieur
du bâtiment